



ARADHANA LUXURIA  
Opp. Eden Parmeshwar, Nr. The H B Kapadia New High School, Chandkheda, Ahmedabad-382424.  
☎ 99 780 781 70 ✉ ariseinfra2105@gmail.com 🌐 aradhana-group.com

RERA · PR/GJ/AHMEDABAD/AHMEDABAD CITY/AUDA/RAA00000/000000/000000 | WWW.GUJRERAR1.GUJARAT.GOV.IN

10.11 design > 99211395

PROJECT BY

ARISE  
INFRA

DESIGN BY

JIDS  
ASSOCIATES

STRUCTURE



3 bhk 'majestic' living & shops



living that  
**reflects your**  
viewpoint

7

storey

42

units

12

shops





lifestyle  
tailored to  
perfection

15+

amenities





where  
**openness**  
becomes your new friend

human size games

open yoga space

open gazebo

walking space

senior citizen seating area

walkway garden

open gazebo

gazebo seating



# the distinct tones of entertainment



club house



indoor game



gym



yoga deck



garden



senior citizen  
sitting



children play



sand pit



library



drop of zone



entrance foyer



security cabin



fire system



cctv camera



solar panel





# g

ground floor

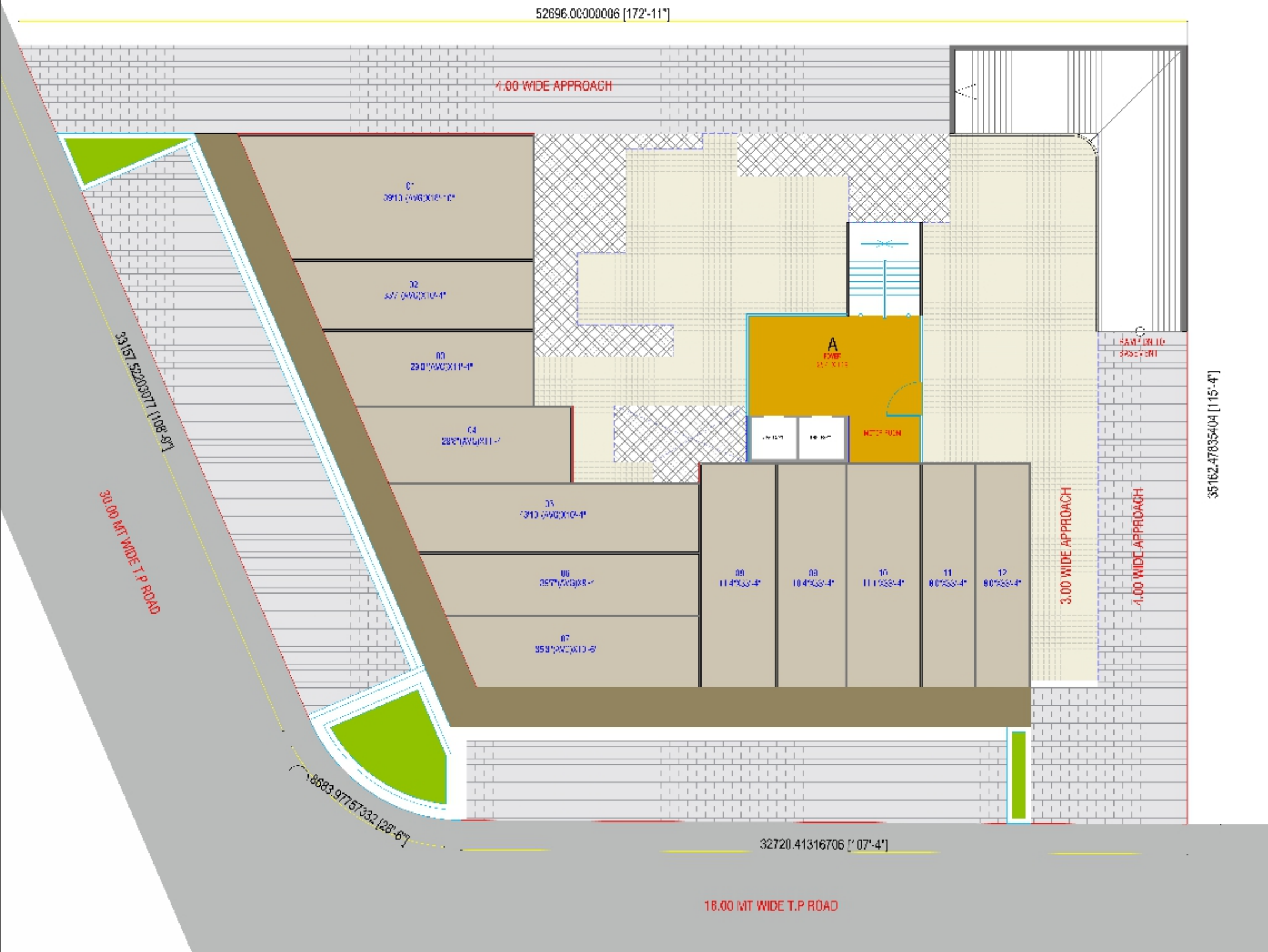

# t

typical floor





3 bhk







## specifications

### WALL FINISH

Internal : Smooth finish mala plaster with putty  
External : Double coat sand faced plaster texture finish.

### FLOORING

Vitrified tiles flooring in all room.

### KITCHEN

Standing polished natural granite kitchen platform with sink & Glazed tiles dado above the platform up to lintel

### DOORS

Decorative main door having lock of reputed company.  
Internal doors of flush doors.

### WINDOWS

Aluminium anodized section sliding windows with glass & stone jambs.

### TOILET

Ceramic tiles flooring in all toilets, glazed tiles dado up to lintel level.

### PLUMBING

Concealed plumbing of good quality UPVC & CPVC PIPES, C.P. Fittings & Sanitary Ware of reputed brands.

### ELECTRIFICATION

Signal phase meter + MCB & ELCB tripper with concealed wiring with adequate points with quality fittings.

### PAINT

Exterior painting of acrylic paint. Internal walls double coat putty finish.

### LIFTS

Fine quality fully automatic lifts.





**RULES & REGULATIONS** • Stamp Duty, Registration Charges, Legal Documentation Charges, GST, Maintenance Deposit, Torrent Charges and any other charges shall be borne by buyer separately. • Any Additional charges of duties levied by government / local authority during or after the completion of the project will be borne by the buyer. • Internal changes shall be done with prior permission and shall be charged in advance. • Changes in external elevation shall not be permitted. • All rights reserved by the developer for alteration / modification / improvement in specification / changes in dimensions and planning shall be binding to all. • Business practices leading to pollution, causing material damage to the building or members are not allowed in the premises. • Irregular payments may attract interest or lead to cancellation of booking/s.

**DISCLAIMER** • This brochure and model are not part of any legal documents. • All dimensions / measurement given are unfinished and approximates. • The photographs & artistic impressions are for references only. Actual building may vary from the representations mentioned in the brochure. • This is not an advertisement within the meaning of RERA. This is not an offer, invitation or commitment of any nature. Recipients are advised to appraise themselves of the necessary and relevant information of the project prior to making any purchase decisions. All the specifications of the flat shall be as per the final agreement between the parties. • \* Subject to Ahmedabad jurisdiction • T&C Applicable